

Line Detail Report

Kinetex Inc.

Job No.: _____ Date: April 2007
 Line No.: S-102 Prospect: Flin Flon 3D
 Pattern: 1 Kg @ 5 Meters Source Interval: 50 M Compiled By: HOB0 Page 1 of 1
 Direction: S ← N

Legend

- Shotpoint or Skid ○
- Nohole ●
- Powerline
- Pipeline
- Creek
- Fence

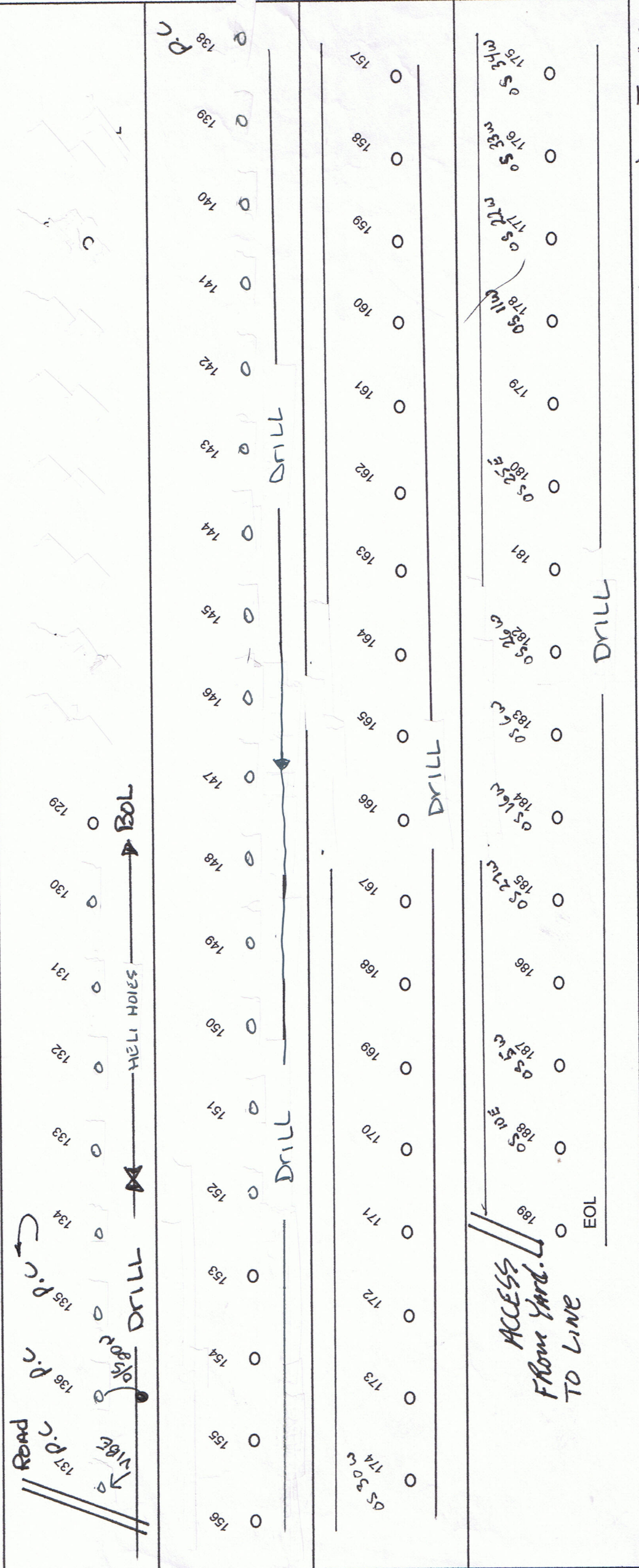

(153-189) BO JENSEN

Legend

- Shotpoint or Skid
- Nohole
- Powerline
- Pipeline
- ↪ Creek
- X-X-X-X- Fence

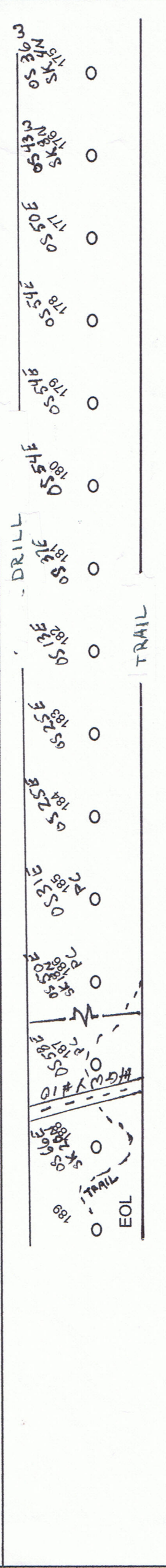
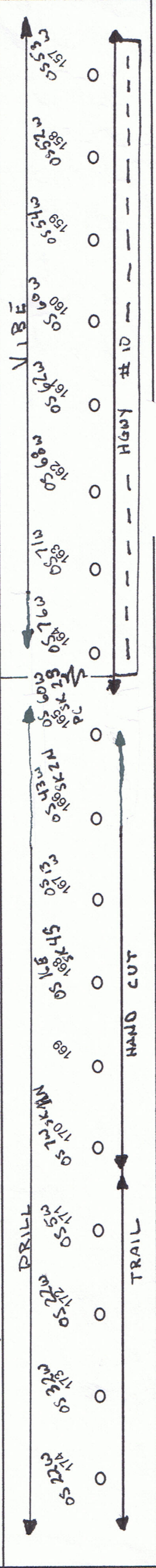
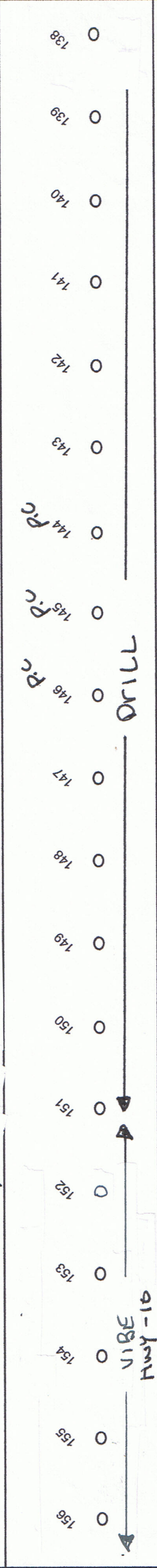
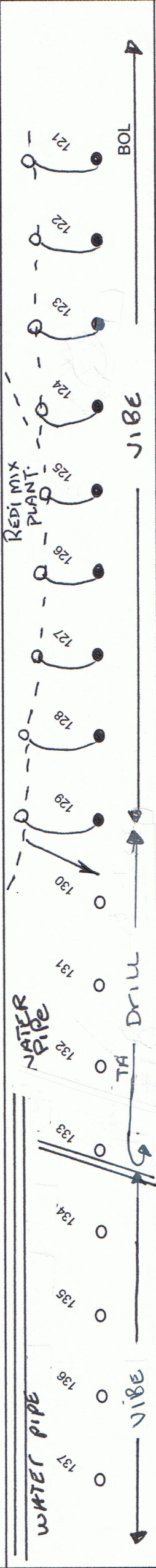

BO SENSEN

Legend

- Shotpoint or Skid
- Nohole
- Powerline
- Pipeline
- ↪ Creek
- X—X—X— Fence

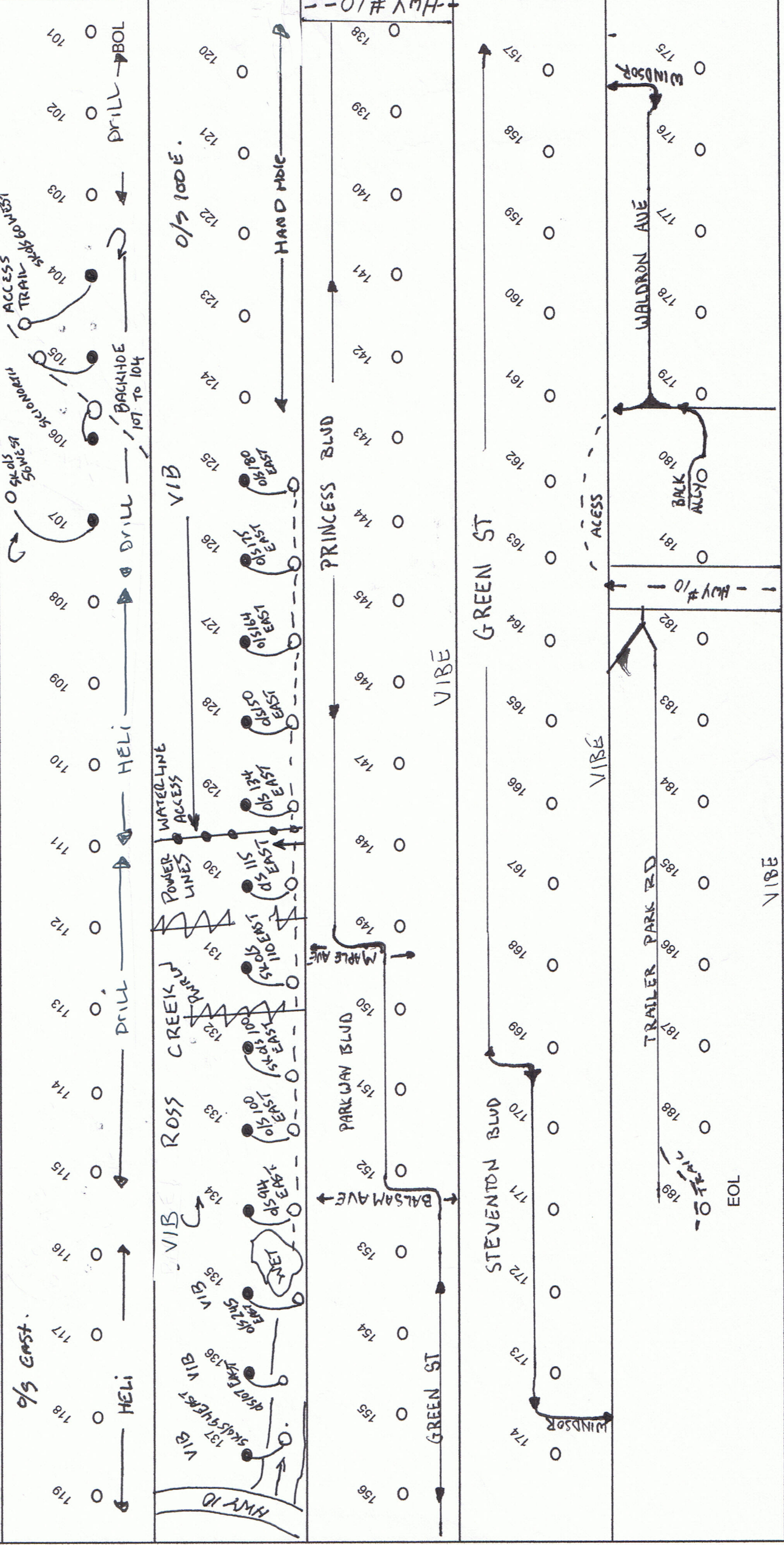

Line Detail Report

Kinetex Inc.

Job No.: _____

Client: Hudson Bay Mining and Smelting

Prospect: Flin Flon 3D

Date: April 2007

Source Interval: 50 M

Direction: S ← N

Compiled By: HOB0 Page 1 of 1

Pattern: 1 Kg @ 5 Meters

Legend

- Shotpoint or Skid ○
- Nohole ●
- Powerline (zigzag line)
- Pipeline (line with dots)
- Creek (wavy line)
- Fence (line with X's)

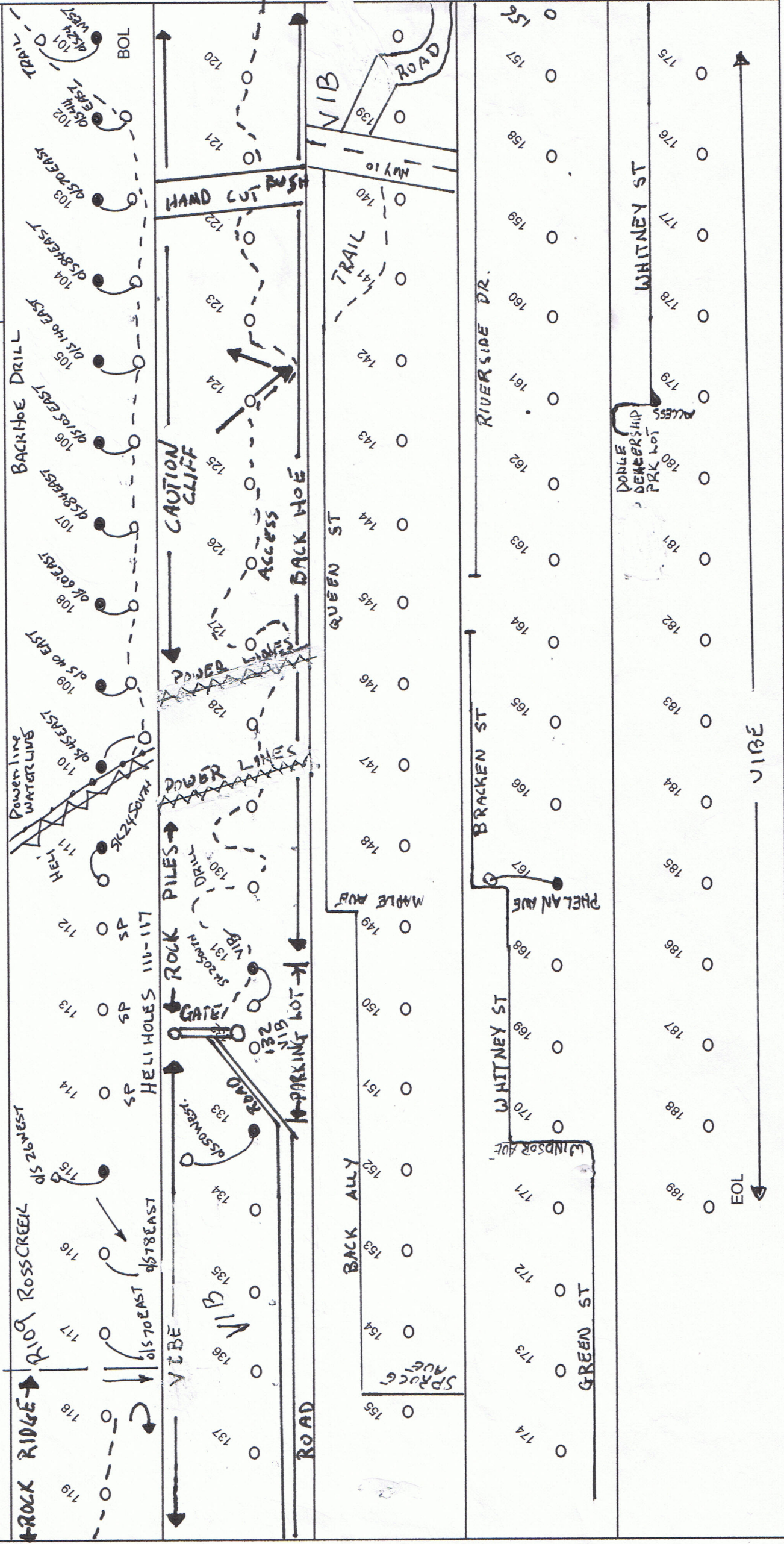

EOL

VIBE

Line Detail Report

Kinetex Inc.

Job No.: _____ Date: April 2007
 Line No.: S-112 Prospect: Flin Flon 3D
 Pattern: 1 Kg @ 5 Meters Source Interval: 50 M Direction: S ← N
 Compiled By: HOBO Page 1 of 1

Legend

- Shotpoint or Skid:
- Powerline:
- Pipeline:
- Nohole:
- Creek:
- Fence:

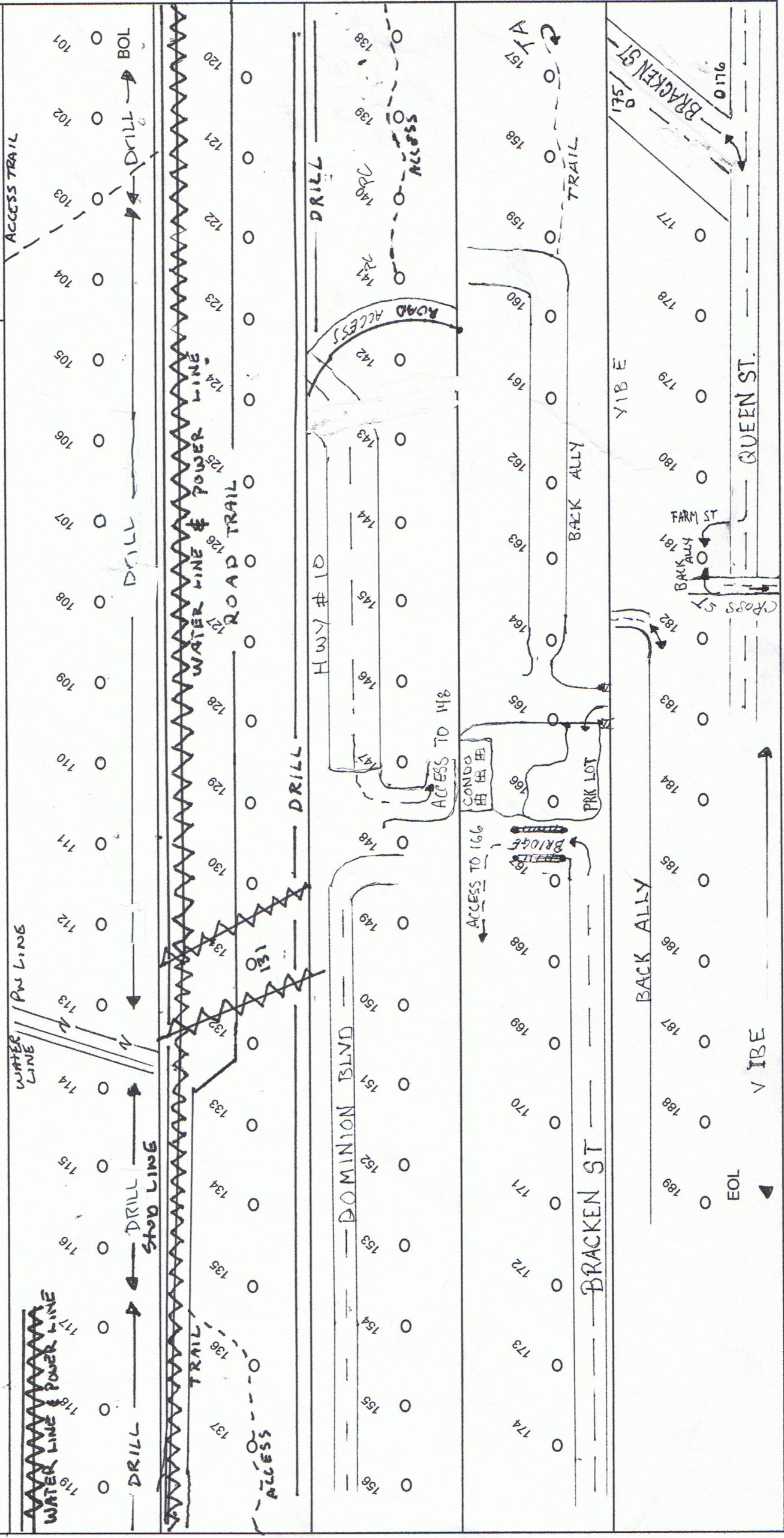

Line Detail Report

Kinetex Inc.

Job No.: _____ Date: April 2007
 Line No.: S-114 Prospect: Flin Flon 3D
 Pattern: 1 Kg @ 5 Meters Source Interval: 50 M Compiled By: HOBO Page 1 of 1
 Direction: S ← N

Legend

- Shotpoint or Skid ○
- Nohole ●
- Powerline
- Pipeline
- Creek
- Fence

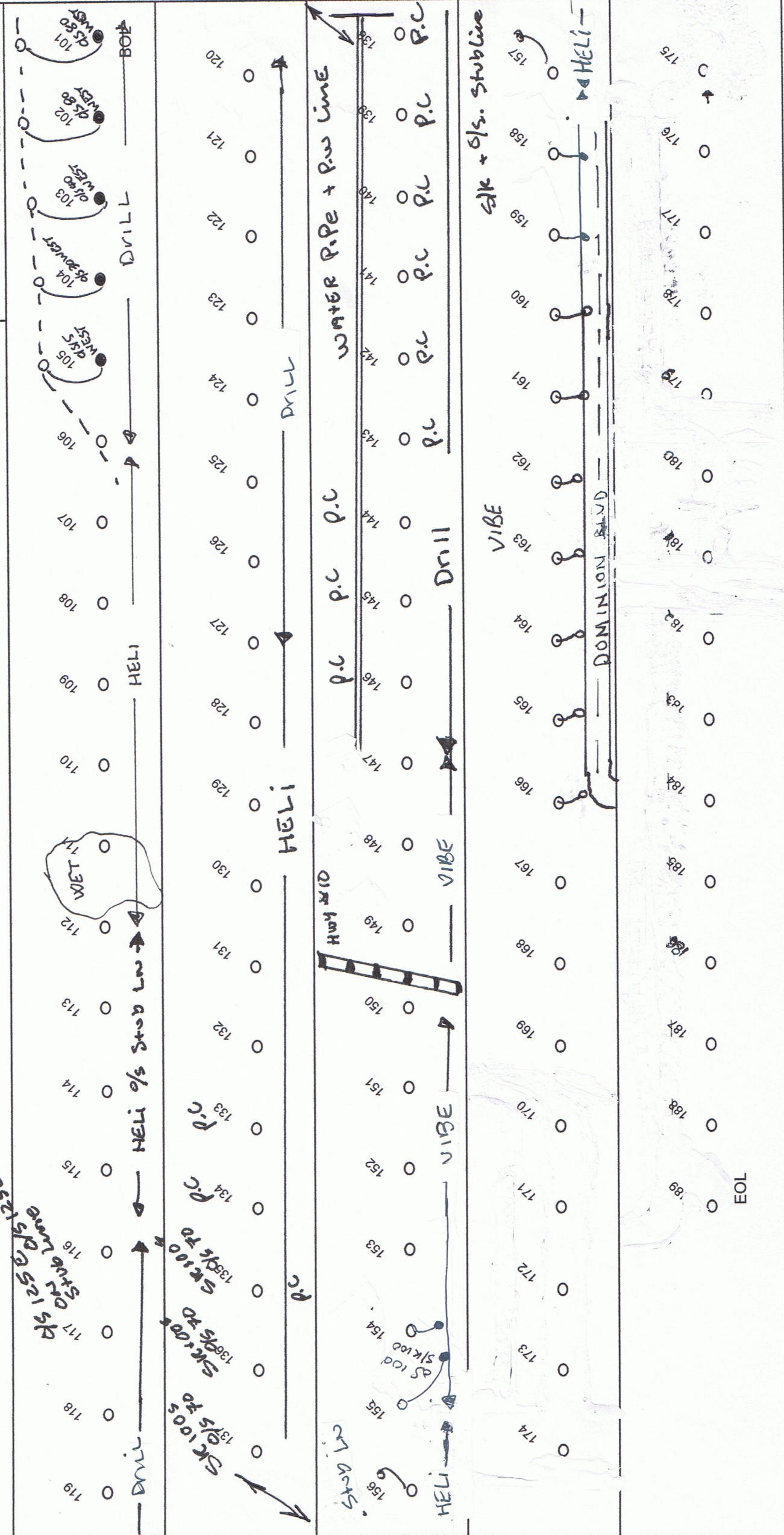

EOL

Line Detail Report

Kinetex Inc.

Job No.: _____ Date: April 2007
Line No.: S-116 Prospect: Flin Flon 3D
Pattern: 1 Kg @ 5 Meters Source Interval: 50 M Compiled By: HOBBO Page 1 of 1
Direction: S ← N

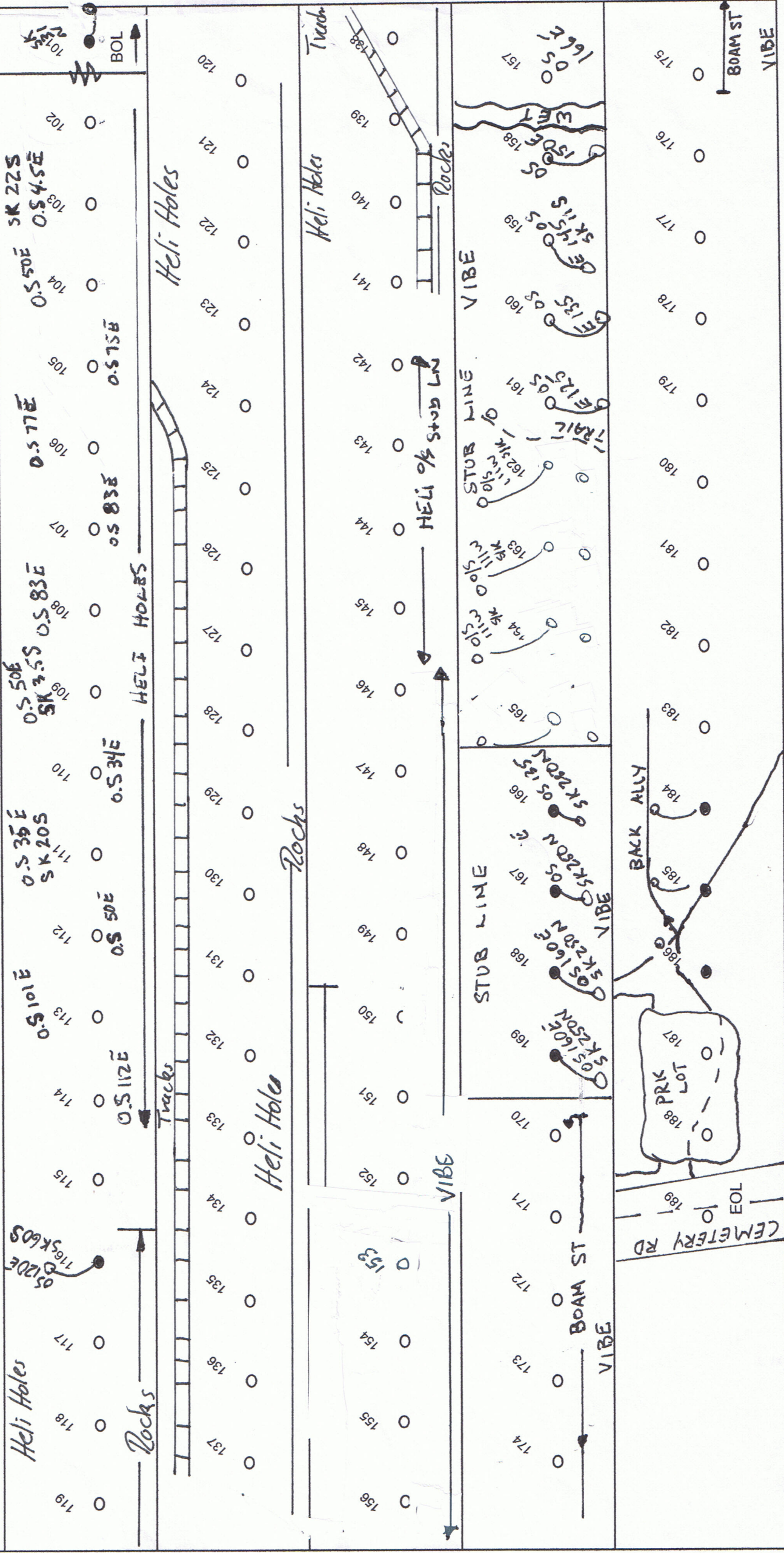
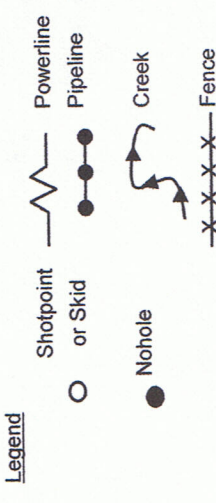

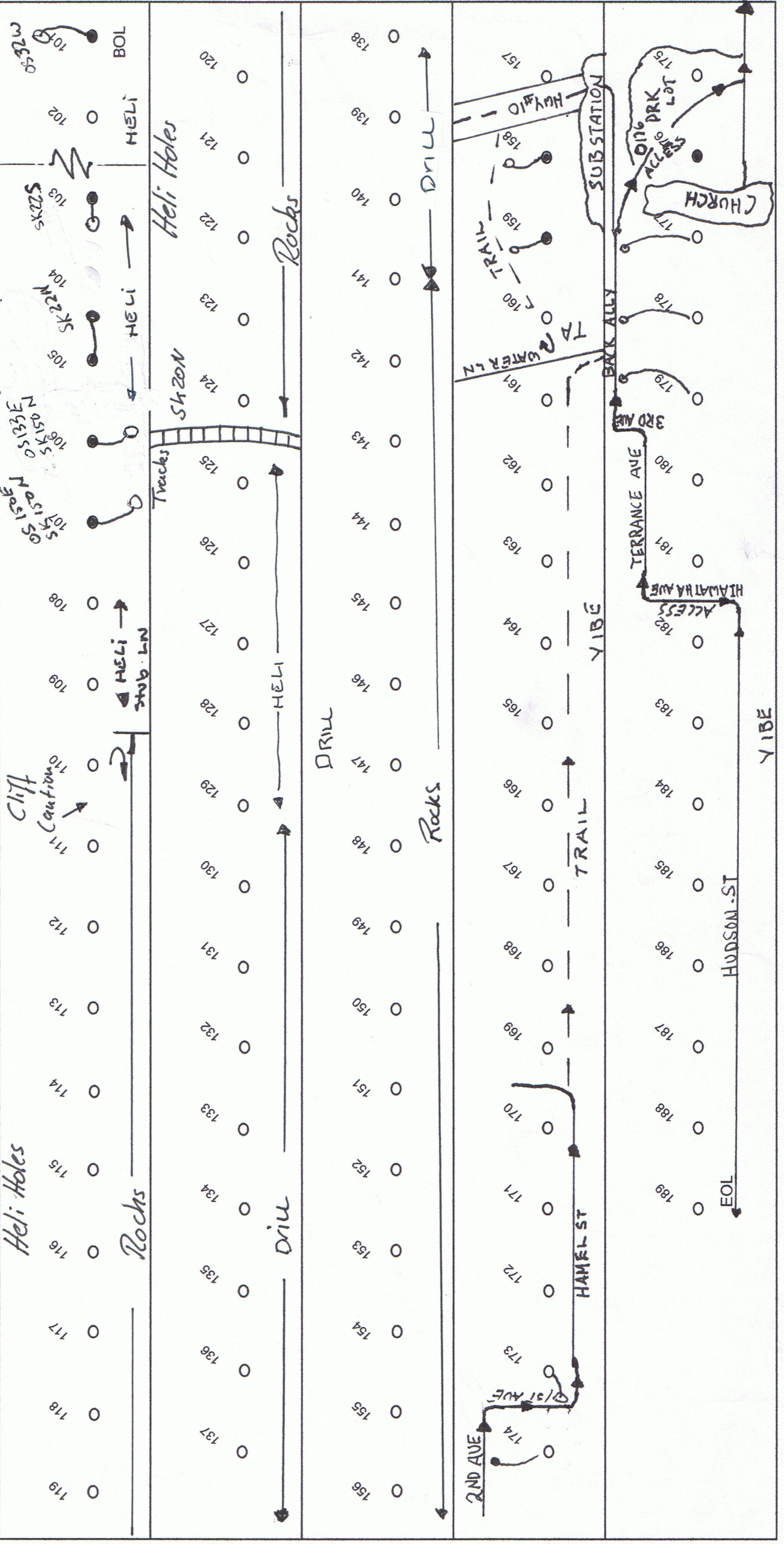

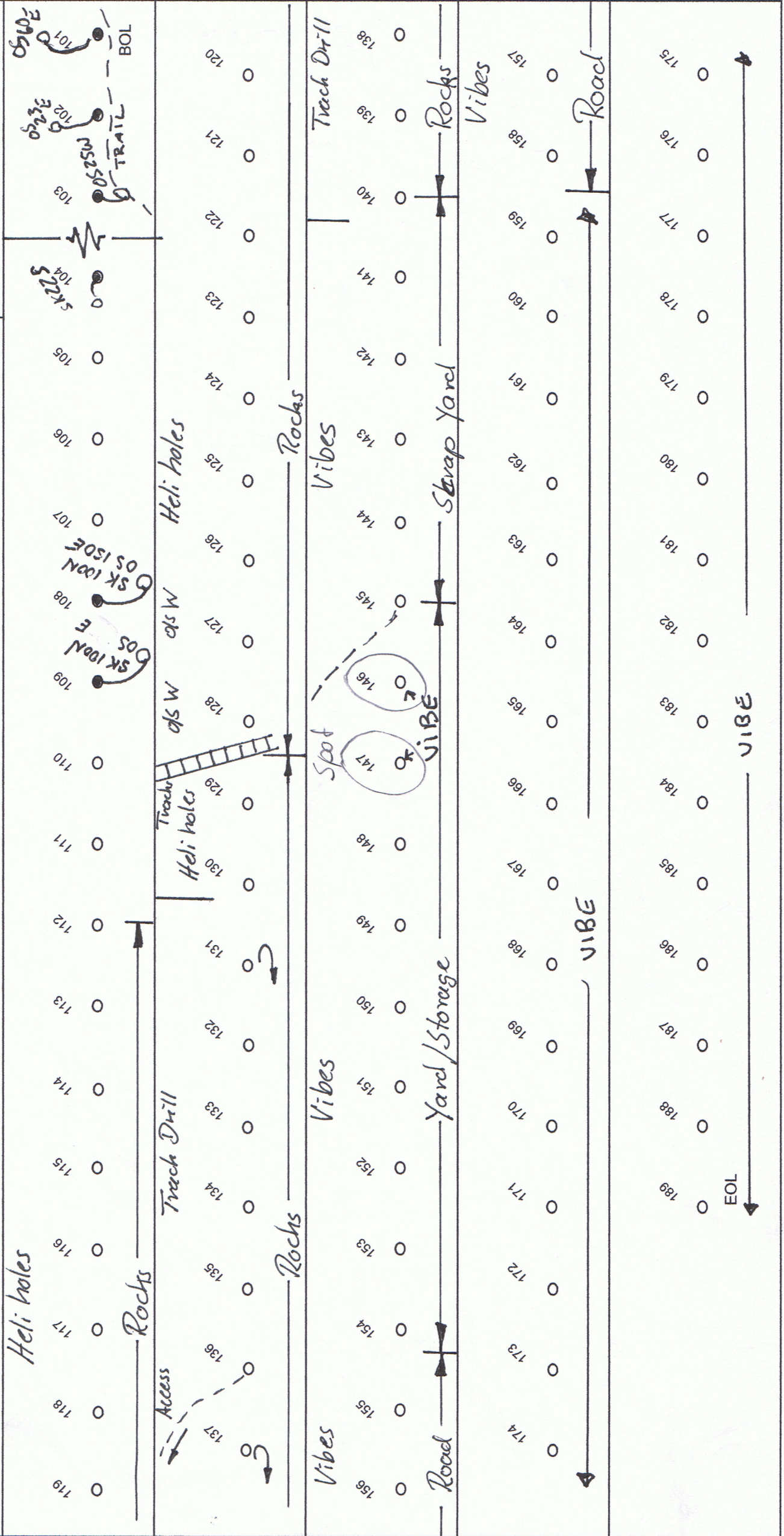

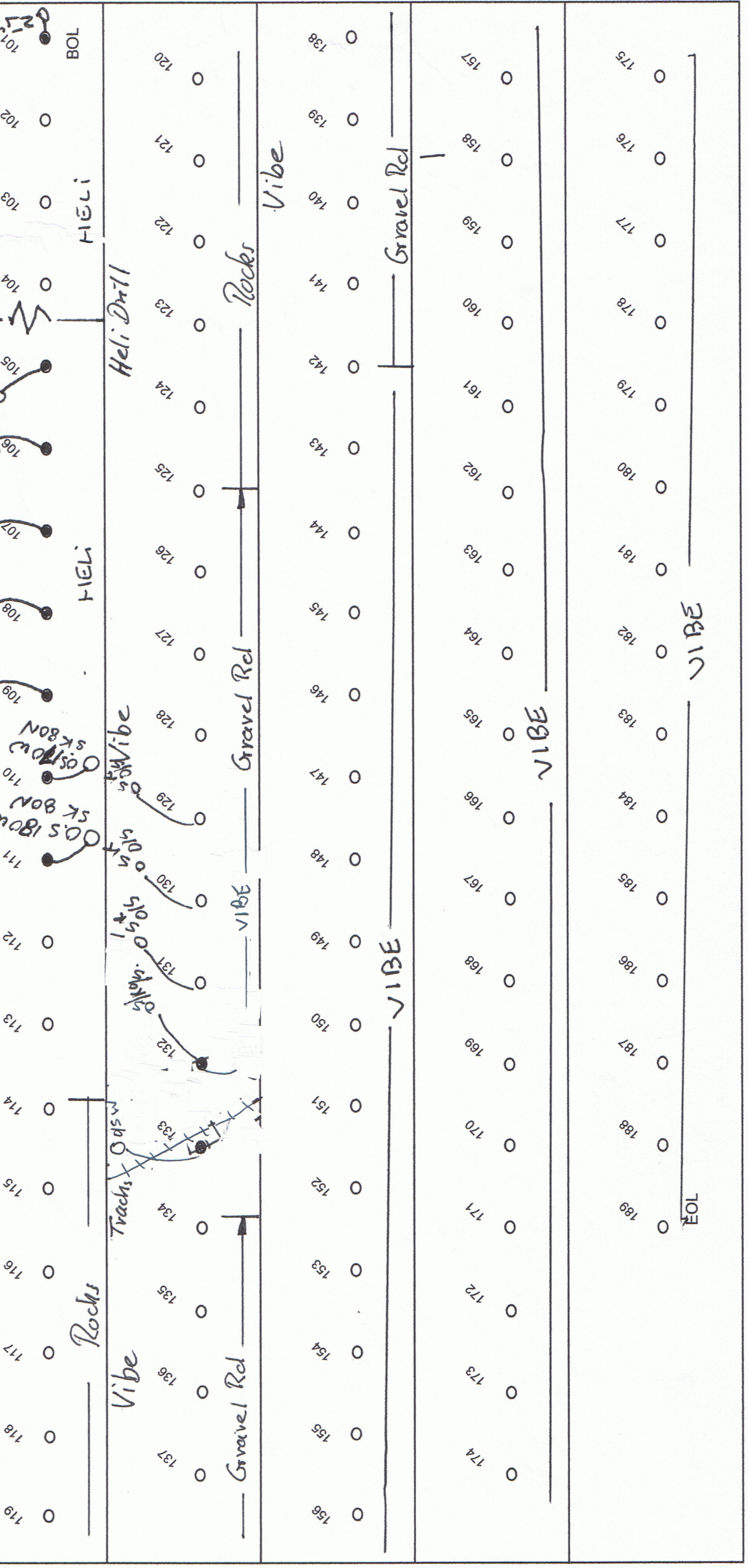

Legend

- Shotpoint or Skid
- Nohole
- Powerline
- Pipeline
- ↪ Creek
- X-X-X-X- Fence

Kinetex Inc. Line Detail Report

Job No.: _____ Date: April 2007

Client: hudson Bay Mining and Smelting Prospect: Flin Flon 3D

Source Interval: 50 M Direction: S ← N

Compiled By: HOBO Page 1 of 1

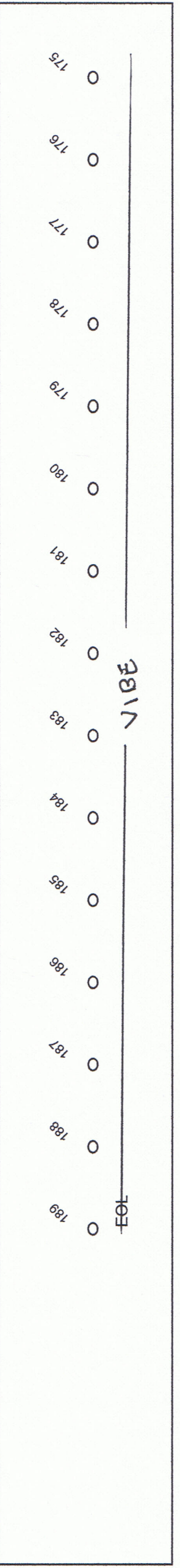
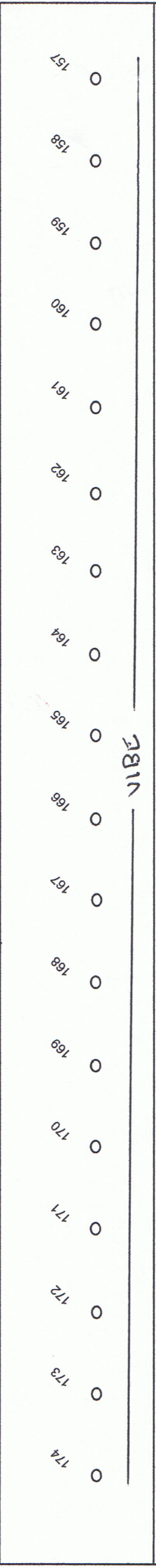
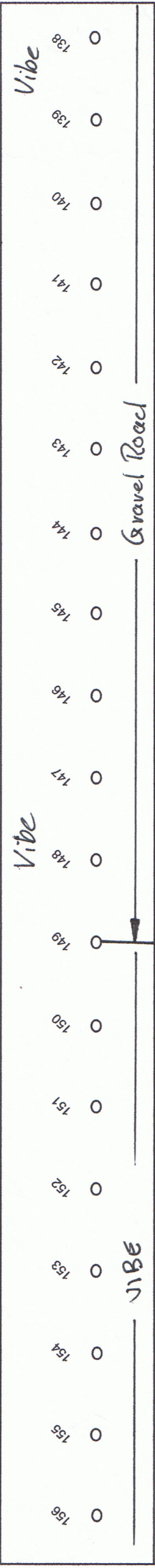
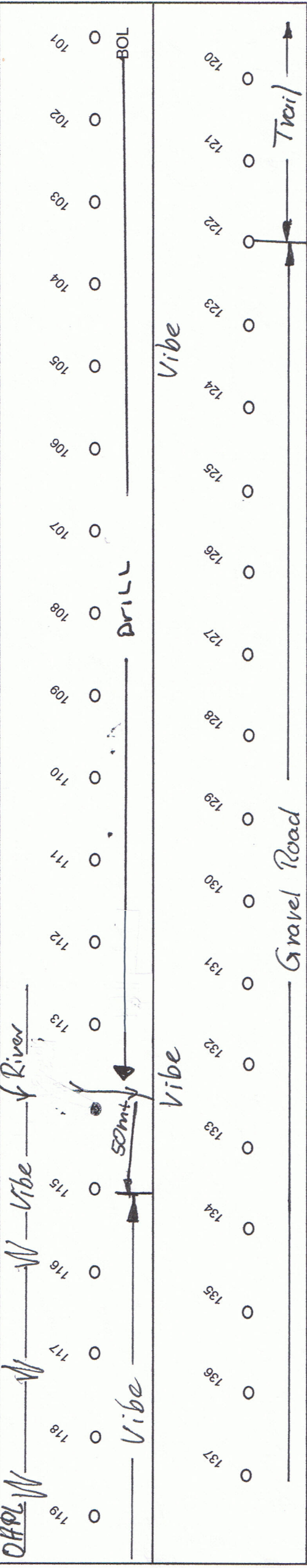

Legend

- Shotpoint or Skid
- Nohole
- Powerline
- Pipeline
- ↻ Creek
- X—X—X— Fence

Line Detail Report

Kinetex Inc. Client: hudson Bay Mining and Smelting Prospect: Flin Flon 3D Date: April 2007

Job No.: _____ Source Interval: 50 M Direction: \leftarrow S N \rightarrow Compiled By: HOBO Page 1 of 1

Line No.: S-128

Pattern: 1 Kg @ 5 Meters

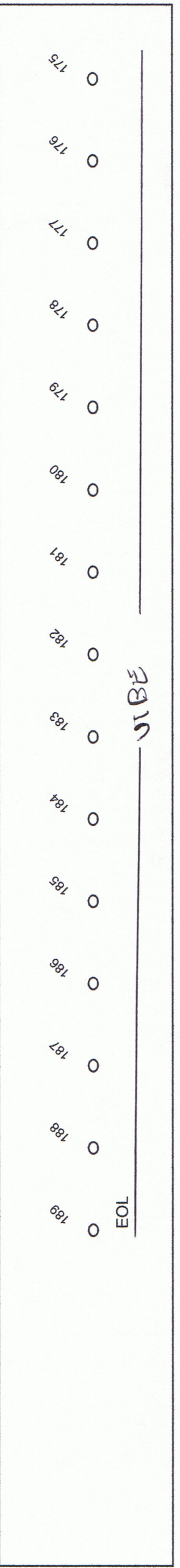
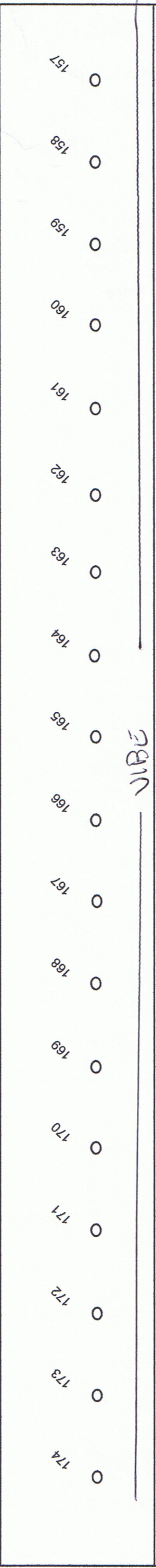
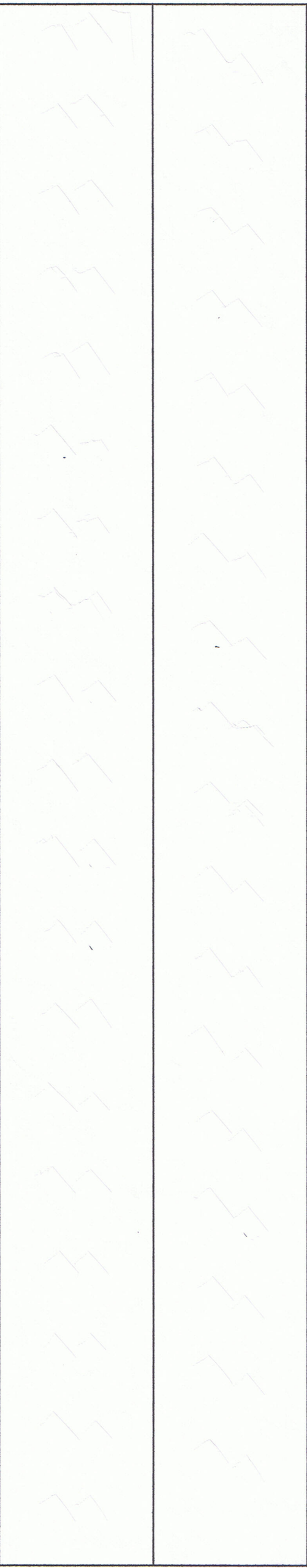

Legend

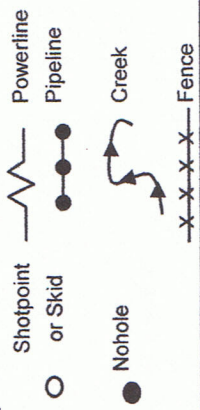

Line Detail Report

Kinetex Inc.

Job No.: _____ Date: April 2007
 Line No.: S-130 Prospect: Flin Flon 3D
 Pattern: 1 Kg @ 5 Meters Source Interval: 50 M Compiled By: HOBO Page 1 of 1
 Direction: S ← N

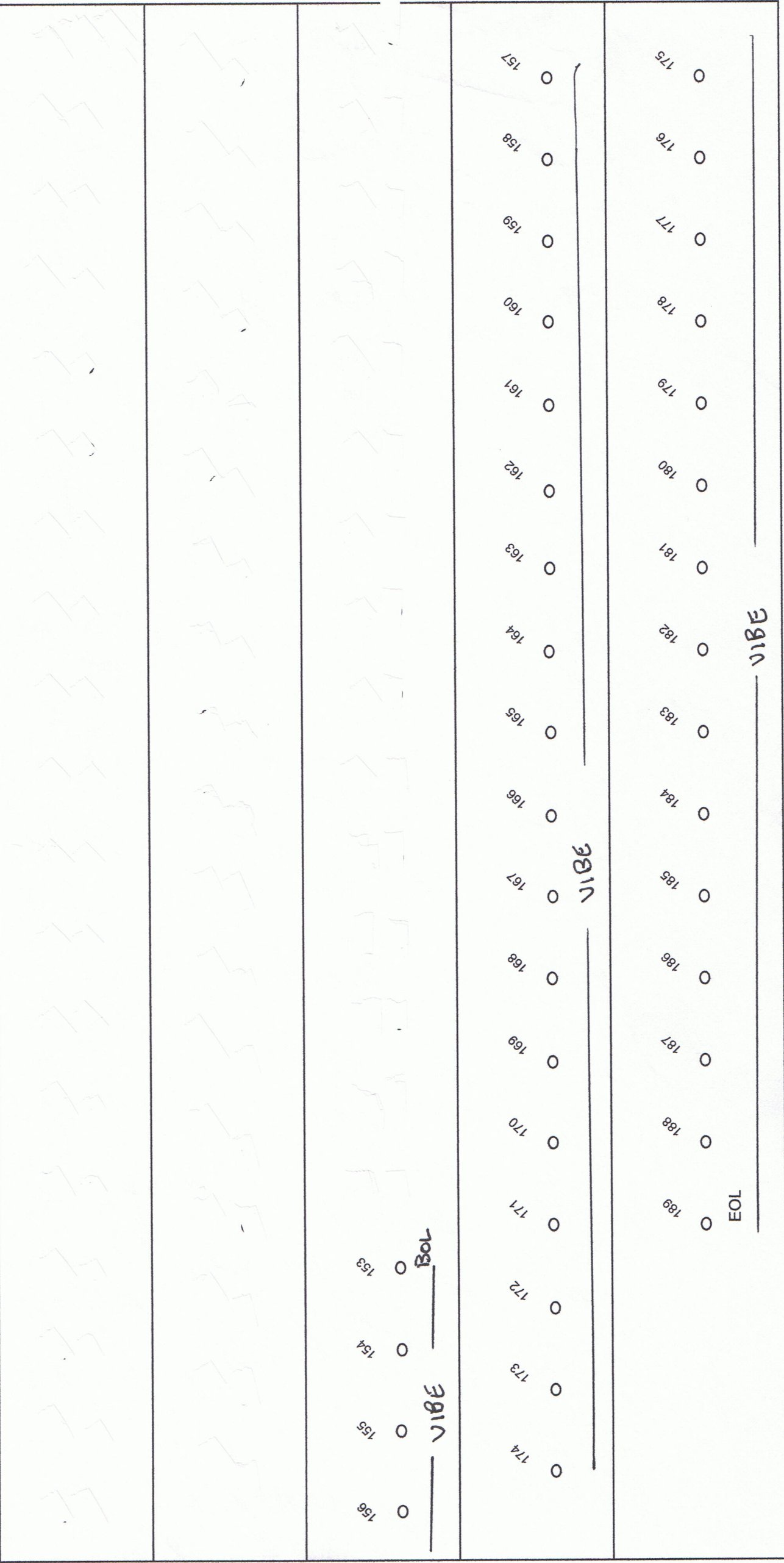

EOL

VIBE

Line Detail Report

Kinetex Inc.

Date: April 2007
Compiled By: HOBBO Page 1 of 1

Prospect: Flin Flon 3D
Direction: S ← N

Client: hudson Bay Mining and Smelting
Source Interval: 50 M

Job No.: _____
Line No.: S-132
Pattern: 1 Kg @ 5 Meters

Legend

- Shotpoint or Skid: ○
- Nohole: ●
- Powerline: — (with zigzag symbol)
- Pipeline: — (with solid circles)
- Creek: — (with wavy line)
- Fence: — (with 'X' marks)

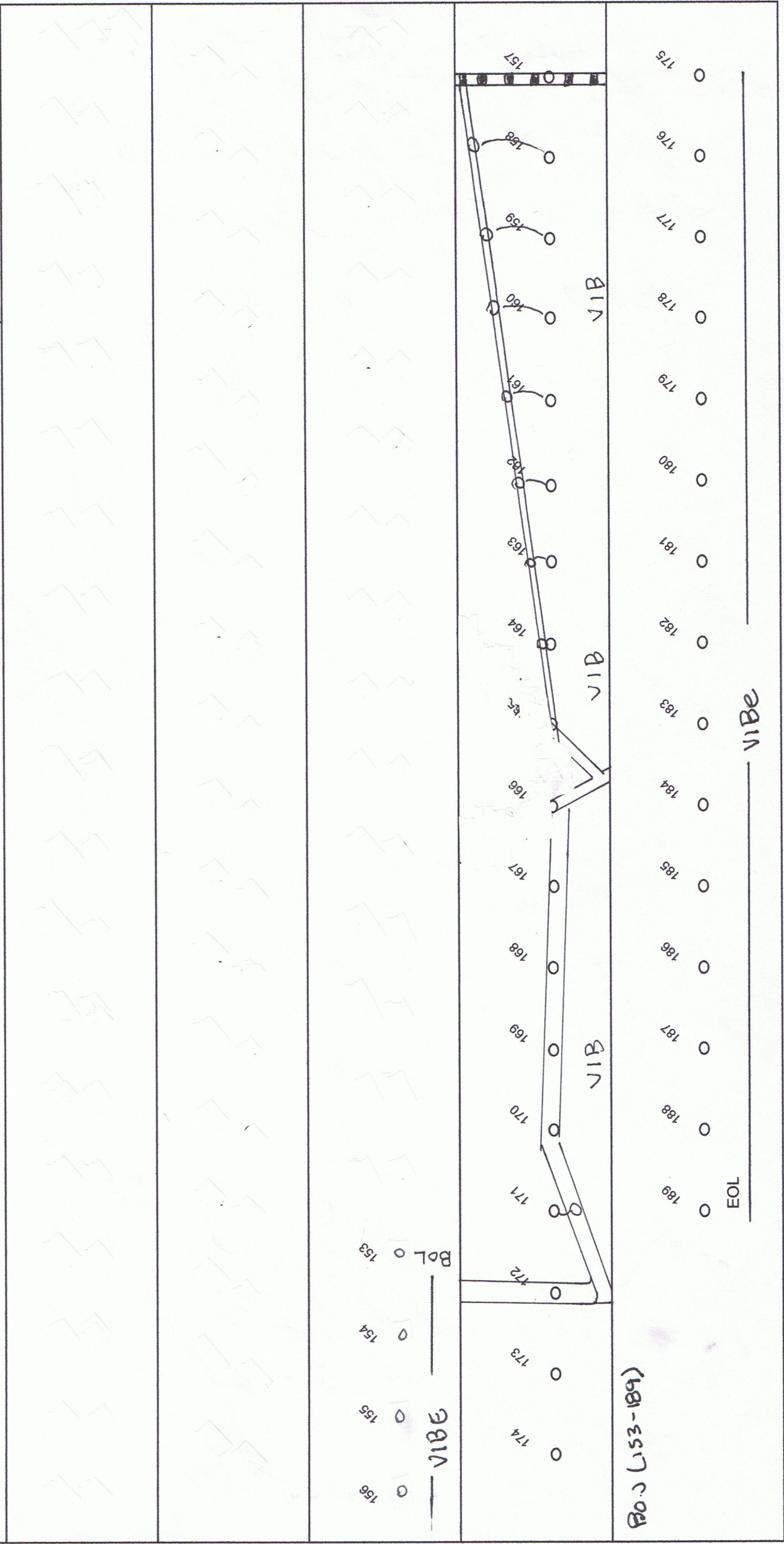

Box (153-189)

EOL

VIB

VIB

VIB

VIB